



WIS 21 Corridor Preservation Plan

Rivermoor Road to US 41

February 2015

Contact information:

WisDOT Northeast Region
944 Vanderperren Way
Green Bay, WI 54304
Phone: (920) 492-5643
Fax: (920) 492-5640

Project Web site:
www.dot.wisconsin.gov/projects/neregion/21

Bryan Lipke, P.E.
WisDOT Project Manager
Phone: (920) 492-5703
bryan.lipke@dot.wi.gov

Kim A. Rudat
WisDOT Communications Manager
Phone: (920) 492-5743
kim.rudat@dot.wi.gov

Mission statement:

To provide leadership in the development and operation of a safe and efficient transportation system.

Included in this issue

Page 1:
Recommended Expressway Alternative

Pages 2-3:
Recommended Roadway and Intersection Configurations

Page 4:
What is an Official Map?
Public Meeting Invitation

Recommend alternative to be presented on the WIS 21 Corridor

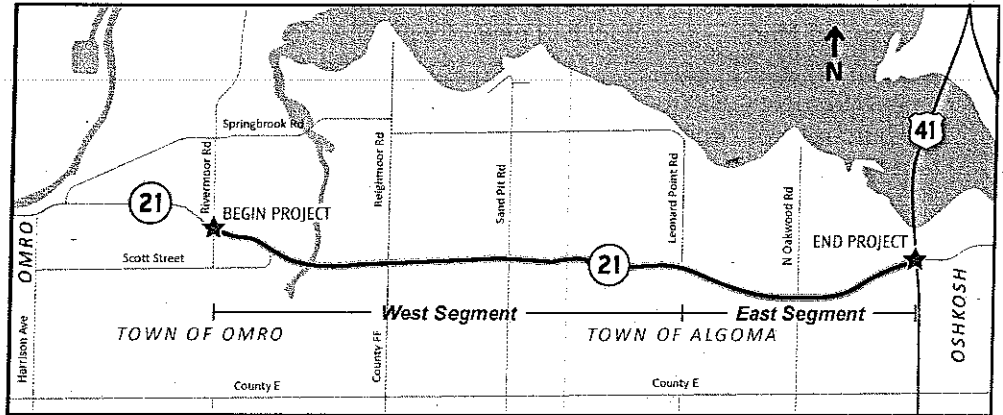

WIS 21 Corridor Study limits: Rivermoor Road to US 41

The Wisconsin Department of Transportation (WisDOT) has been working with local stakeholders to develop a long range plan for the future of the WIS 21 corridor between Omro and Oshkosh in Winnebago County. The plan will preserve corridor functionality and safety in response to changing traffic conditions and planned development in this important transportation corridor. No construction is scheduled.

Comments received at the May 2013 public involvement meeting (PIM) dealt with the inclusion of roundabouts and J-turns within the study corridor, concerns related to changes in access due to the addition of medians and the relocations of unsafe driveways, and the impacts to residences and businesses located within the corridor.

The study team has completed several tasks, including:

- Environmental surveys for wetlands and endangered species
- Coordination with the Wisconsin Department of Natural Resources and the US Army Corps of Engineers
- Utility coordination
- Detailed analysis of alternative impacts
- Detailed analysis of alternative intersection types
- Hybrid alternative recommended for the WIS 21 corridor

A public involvement meeting is scheduled to present the recommended alternative, to outline the official mapping process and to gather opinions from corridor residents and travelers. The meeting will be held on **Wednesday, April 22, 2015** from 5:30 p.m. to 7 p.m. at Oakwood Elementary School, 1225 North Oakwood Road, Oshkosh. See page 4 for more information.

Recommended roadway configurations

The study team presented multiple roadway alternatives for the future expressway facility at the previous public meeting. For the East Segment, a transitional roadway with a raised median and curb and gutter with a terrace and sidewalk in each direction was presented. For the West Segment, four roadway expansion alternatives to improve WIS 21 from a 2-lane facility to a 4-lane expressway were presented:

- Expand North – construct two new lanes to the north
- Expand South – construct two new lanes to the south
- Hold Existing Right of Way – construct the 4-lane facility to avoid impacts to parcels impacted by the 1980s purchase of additional right of way
- Hybrid Expansion – construct two new lanes to the north between Rivermoor Road and Spring Brook and construct two new lanes to the south between Spring Brook and Leonard Point Road.

After comments about the alternatives were gathered from the public and local officials, the project team evaluated the environmental and social impacts, construction costs, and safety/operational benefits for each alternative to recommend the following 4-lane expressway alternatives:

- East Segment – Transitional Roadway
 - o Long-term term solution with the ability to provide a safe and efficient transportation system for both local and regional traffic
 - o Better enhances mobility for non-motorized users by providing safe facilities for pedestrians and bicyclists
- West Segment – Hybrid Expansion
 - o Long-term solution with the ability to provide a safe and efficient transportation system for both local and regional traffic
 - o Constructable under traffic with a lower construction cost than the three other expansion alternatives
 - o Lower environmental impacts, right of way acquisition, and relocations than the three other expansion alternatives
 - o Better utilizes the previously purchased additional right of way along the West Segment

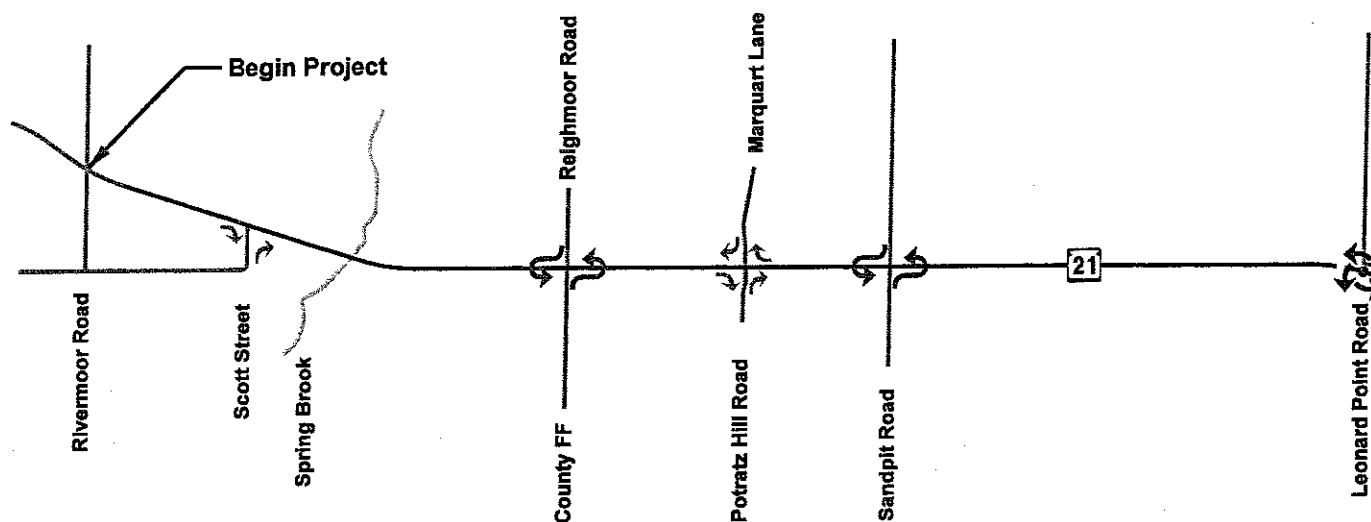

Recommended intersection options

Several intersection treatment alternatives were evaluated for intersection control along the WIS 21 corridor. The intersection control evaluation process has recommended the use of roundabouts at Leonard Point Road, Oakwood Road, and Westhaven Drive/Emmers Lane rather than signals along the East Segment of the WIS 21 Corridor. This recommendation is based on public input received at the last PIM, maintaining a

uniform driver expectancy, safety, and traffic operation evaluations. The West Segment intersections are currently controlled with stop signs on the side roads. J-turns and right-in/right-out intersections are recommended along this segment.

Below are illustrations showing the various alternatives selected and an exhibit of the corridor recommendations.

J-turn

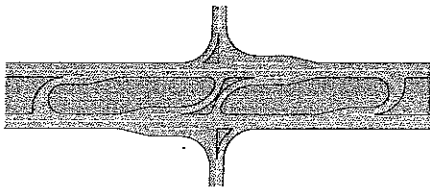

Right-in/Right-out

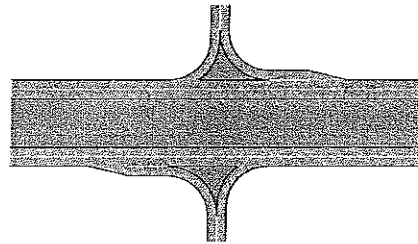

Roundabout

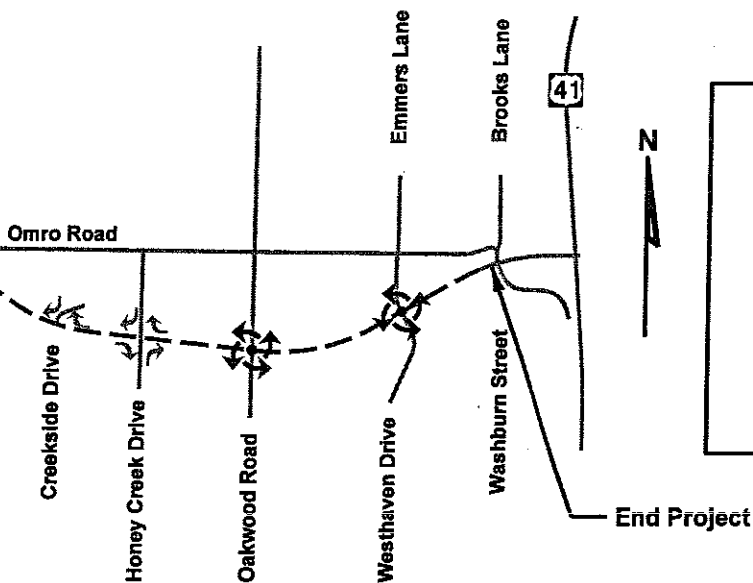
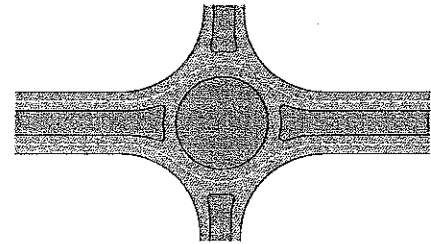

WIS 21 Corridor Recommendations	
	4-Lane Hybrid Expansion
	4-Lane Transitional Raised Median
	Right-In/Right-out
	J-Turn
	Roundabout



WIS 21 Corridor Preservation Plan
Rivermoor Road to US 41

What's Next

Select preferred alternative	Spring 2015
Prepare environmental document	Winter 2015-2016
Public hearing for Environmental Assessment (optional)	Spring 2016
Preliminary design	Summer 2016
Public hearing for official map	Fall 2016

What is an Official Map?

A preferred alternative for the WIS 21 Corridor in Winnebago County between Rivermoor Road and US 41 will be identified at the conclusion of the environmental document. Under Wisconsin Statute 84.295, WisDOT can use an official map to designate property needed to convert a state highway to an expressway in the future. Official mapping provides WisDOT the ability to proactively work with land owners in advance of an approved construction project. Official mapping also informs and helps land owners, the public and local communities plan so that their improvements don't conflict with future expressway conversion.

**Public Involvement Meeting
Month --, 2015**

You are invited to a public involvement meeting for the WIS 21 Corridor Preservation Study. The meeting will be held in an open house format with a short presentation. Exhibits and project information will be available for review and comment.

Please attend - your input is very valuable in determining the future of the corridor.

When: Wednesday, April 22, 2015
5:30 p.m. to 7 p.m.
Presentation at 5:45 p.m.

Where: Oakwood Elementary School
1225 N Oakwood Road
Oshkosh, WI 54904

Project Web site: www.dot.wisconsin.gov/projects/region/21

Wisconsin Department of Transportation
944 Vanderperren Way
Green Bay, WI 54304
Phone: (920) 492-5643
Fax: (920) 492-5640
Email: ner.dtsd@dot.wi.gov

